



"Techno - Social Excellence"

**Marathwada Mitramandal's  
Institute of Technology (MMIT)**



Accredited with "A" Grade by NAAC

Survey No. 35, Vadgaon Shinde Road, Lohgaon, Pune - 411 047

Approved by AICTE, New Delhi, Recognised by DTE, M.S. Mumbai, Affiliated to Savitribai Phule Pune University

Email : principal@mmit.edu.in Website : www.mmit.edu.in

Tel No. : +91 7447786623 / +91 7447786624

**DTE Institute Code : 6203**

## A REPORT

On

## Expert Talk

**Topic :- Introduction to Building  
Information Model**

**Class :- SE**

**Branch :- Civil**

**Venue:Online**

**Date :- 17<sup>th</sup> April 2021**

**Resource Person: Mr. Akshay Shaha**

  
Coordinator

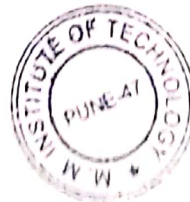

  
HoD Civil

• **Details:**

**Subject :-**CAD Tools Used in Civil Engineering

**Class :-**SE

**Branch :-** Civil

**Venue:**Online

**No. of Student Visited :-**35

**Coordinated by :-**Prof. P.B.Kokate

**Resource Person/ Guest Speaker:** Mr. Akshay Shaha

**Description:**

The session was arranged to guide SE students about various types of CAD Tools and their benefit in Civil Engineering. It was guided by Mr. Akshay Shaha, CAD Manager of CAD Center Vishrantwadi

Some of the options discussed-

- Job of interest
- Self Employment
- Various options in Design Field
- Various types CAD Tools Which is used in Civil Engg.

# Photos of Expert Talk

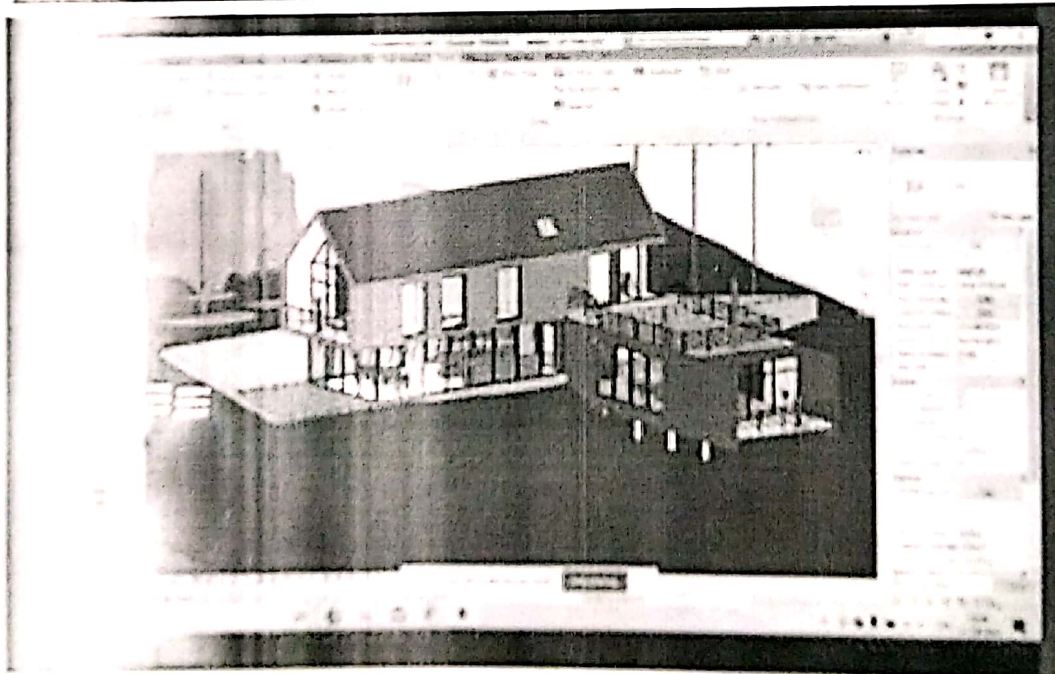
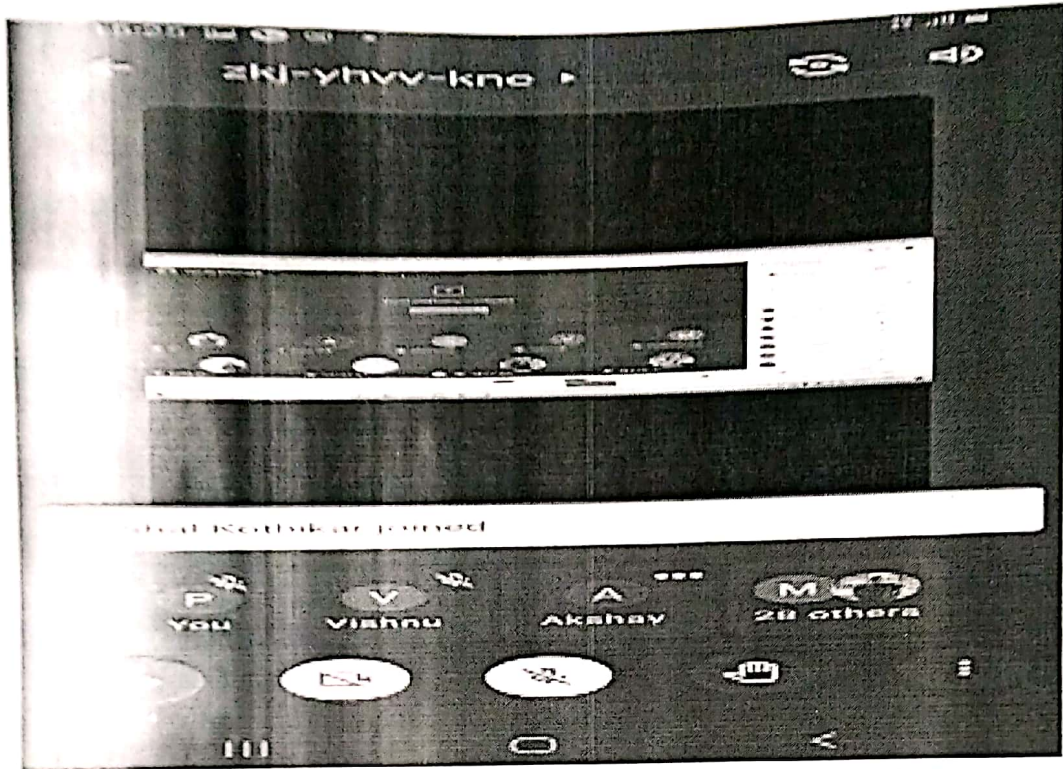

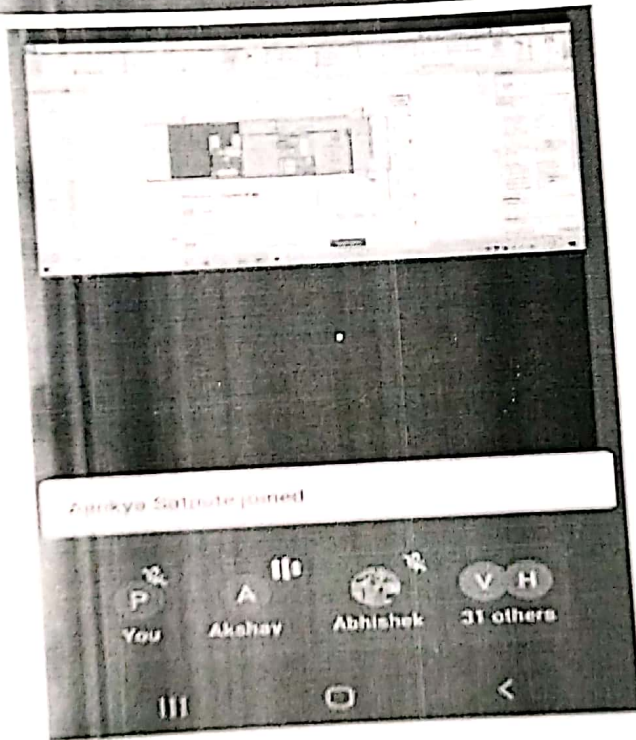
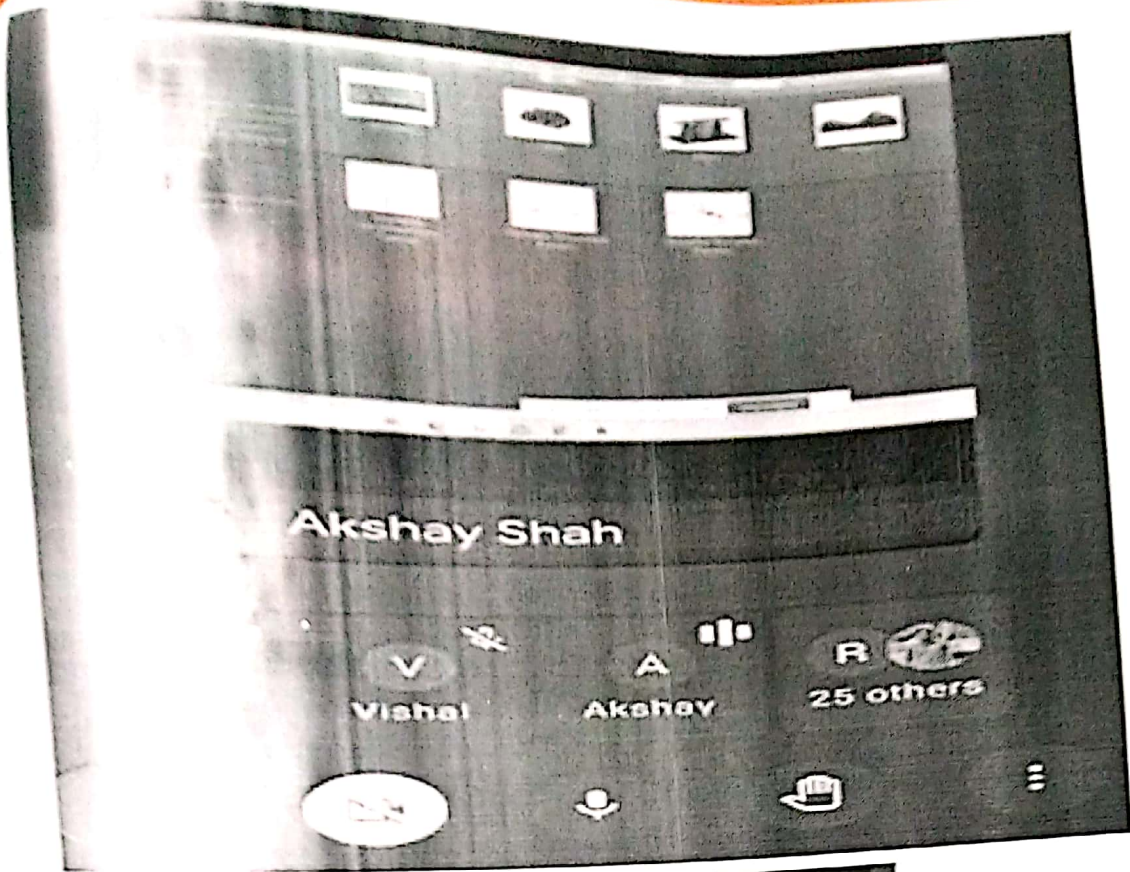



"Techno Social Excellence"  
Marathwada Mithramandal's  
INSTITUTE OF TECHNOLOGY (MMIT),  
Lohagood, Pune 411047



Affiliated to AICTE, New Delhi. Affiliated to KPDE, Pune.

Department of Civil Engineering

INVITATION  
FOR  
EXPERT TALK ON

"CAD Tools Used in Civil Engineering"

17<sup>th</sup> APRIL, 2021 | 3:00 PM  
PLATFORM: GOOGLE MEET

Go-Meet Link: <https://meet.google.com/izkj-yhvv-kne>

TOPIC

"Introduction to Building Information Model"

BY

Mr. Akshay Shaha  
CAD Manager  
CAD Center Nishantwadi, Pune

Feedback Form : <https://drive.google.com/drive/folders/1apHlDE4ucPbP9UJAG8Abqtto28inyjAj>